

These instructions are valid for installation of the TRELLCHEM® Anti-fog lens in TRELLCHEM® gas-tight suits of encapsulating design type VP1 and CV.

TOOLS REQUIRED

A pair of scissors and, preferably, a 12 mm roller.

PREPARATIONS

New suits: First remove the protective film from the suit visor, inside the suit.

Suit with old Anti-fog lens: First remove the old/damaged Anti-fog lens and carefully clean any remaining adhesive on the visor, with solvent (heptane).

PROCEDURE

1) Prepare the new Anti-fog lens by cutting the release paper approximately in the middle of each side.

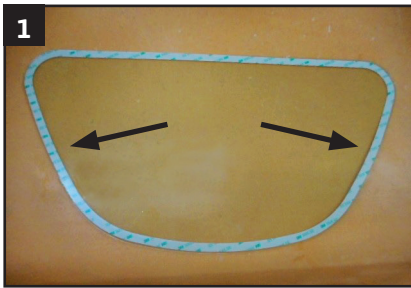

2) Start mounting the Anti-fog lens from one of the cut points on the sides.

- Pull off the tape in small intervals (not all at one time) while pressing the tape onto the visor.
- Move from the middle and downwards and then from the middle and upwards.
- One side at the time.



3) After the first side is finished, continue with the other, until the complete lens is attached.



4) Finally, press the taped edge carefully against the visor. Use your hand or a roller.

